

CUNDALL FARMS METROPOLITAN DISTRICT
ADAMS COUNTY, COLORADO

LGID= 66186

BOUNDARY DATE: 12/16/2009
BOUNDARY SOURCE:
ORDER & DECREE
DATED 12/16/2009
ADAMS COUNTY DISTRICT COURT
CASE. NO. 2009CV1607

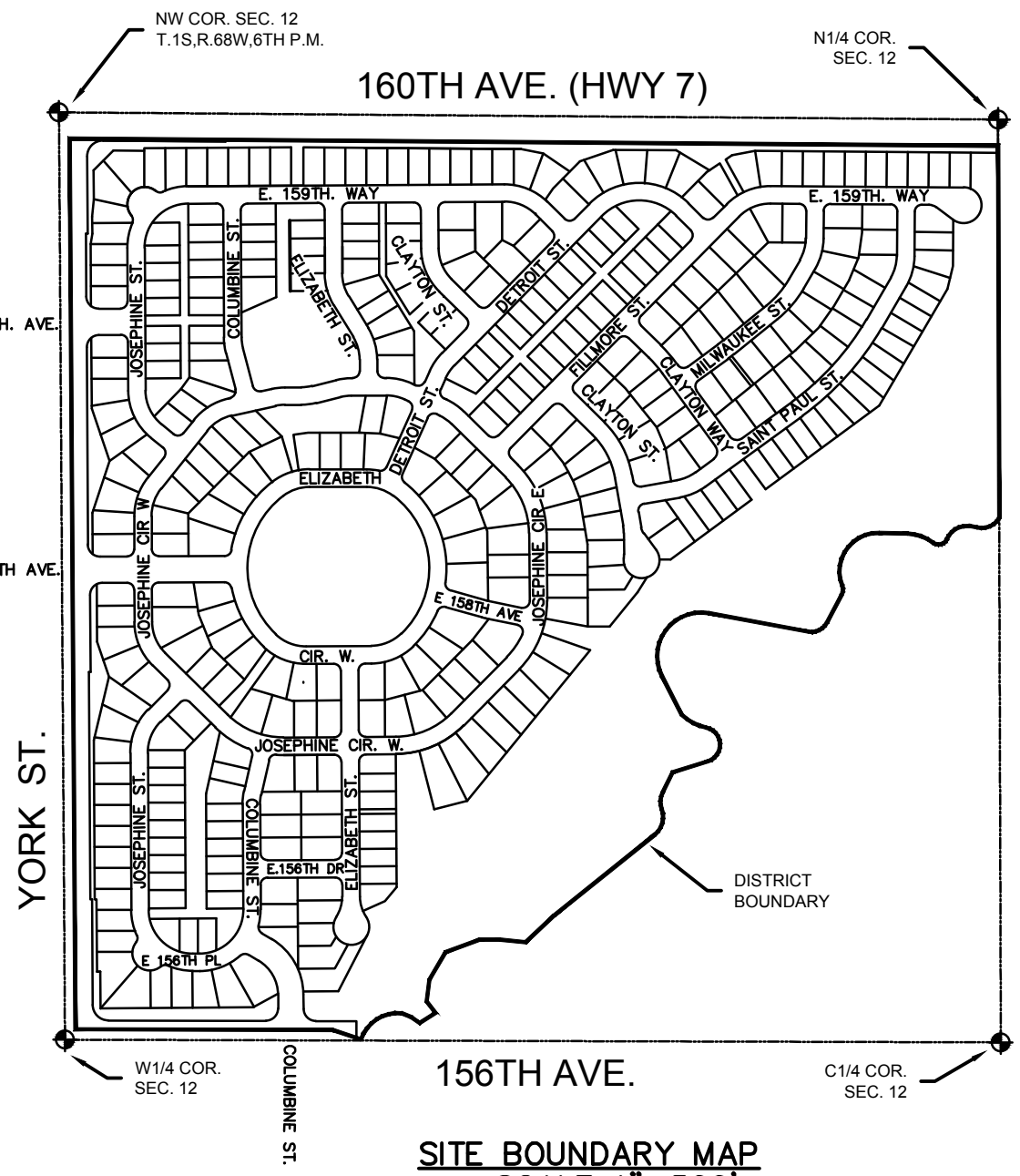

SITE BOUNDARY MAP
SCALE 1"=500'



Peak
Civil Consultants

200 W. HAMPDEN AVE., SUITE 200
ENGLEWOOD, COLORADO 80110
PH: 720.855.3859
FAX: 720.855.3860
CONTACT: JEFF FRENCH